

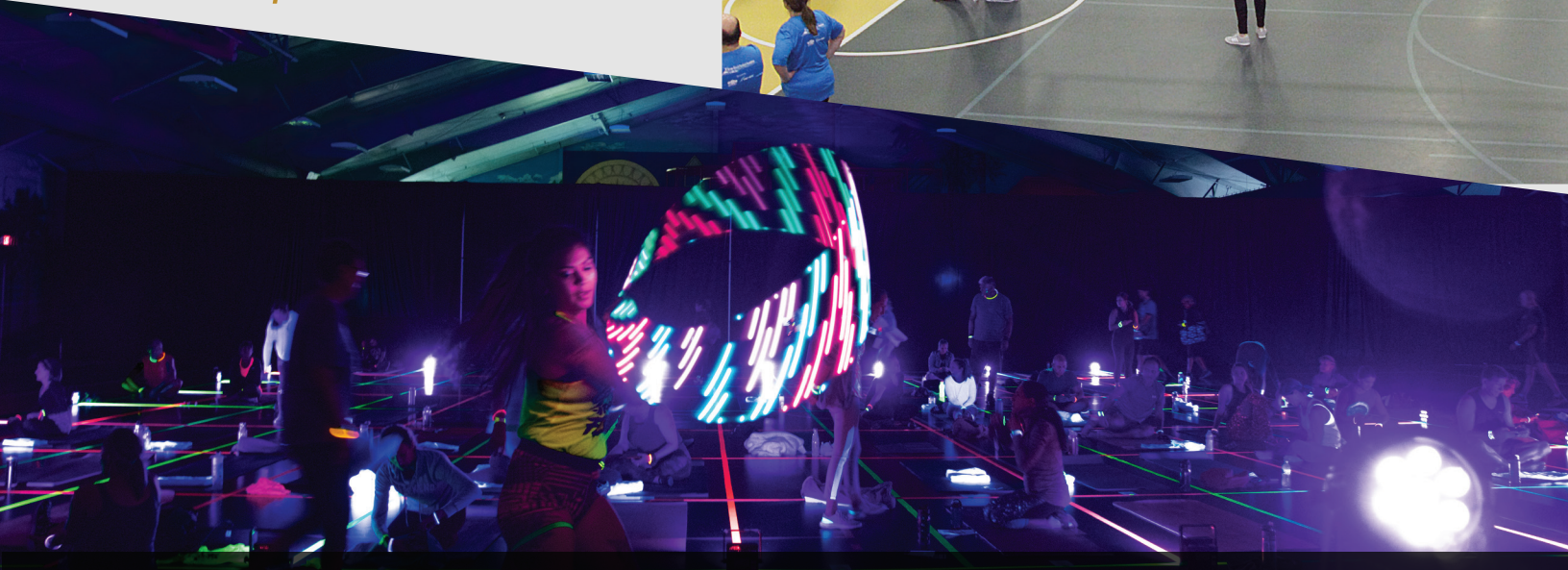

# EVENTS

Elite Sports Club - River Glen is a versatile venue that provides lots of flexible space and plenty of active entertainment for everyone on your guest list. Our on-site staff will handle it all, including the clean-up, ensuring that your event is an enjoyable, stress-free experience.





# THE SPACE



**The Quad**

**DIMENSIONS: 122'X144'**

**CAPACITY: 300**



**Meeting Room**

**DIMENSIONS: 17'X14'**

**CAPACITY: 15**



**Grey Room**

**DIMENSIONS: 47'X30'**

**CAPACITY: 50**



**Exercise Studio**

**DIMENSIONS: 76' X 38'**

**CAPACITY: 100**



**Bar/Lobby Area**

**CAPACITY: 125**



**Junior Lounge**

**CAPACITY: 35**



**Conference Room**

**DIMENSIONS: 28'X16'**

**CAPACITY: 25**

## PRICING

**QUAD PRICING STARTS AT \$450 FOR 2 HOURS.**

**OTHER RENTAL SPACES RANGE  
FROM \$50 - \$175 PER HOUR.**

# THE QUAD



20,000 square feet

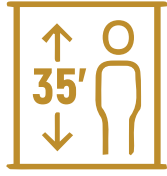

35' to tallest  
point in ceiling



Accommodations for  
50 to 280 guests

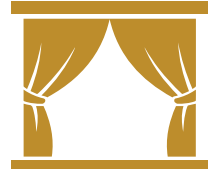

Full stage



Arcade



Hard floor  
& turf flooring



Full bar on premises  
(additional fee)



Wi-fi



Off-street parking



Customizable audio  
& visual options



Catering prep  
& staging space



Tables, chairs & linens  
available for rent

## SAMPLE FLOOR PLAN: SEATED DINNER FOR 250 PEOPLE

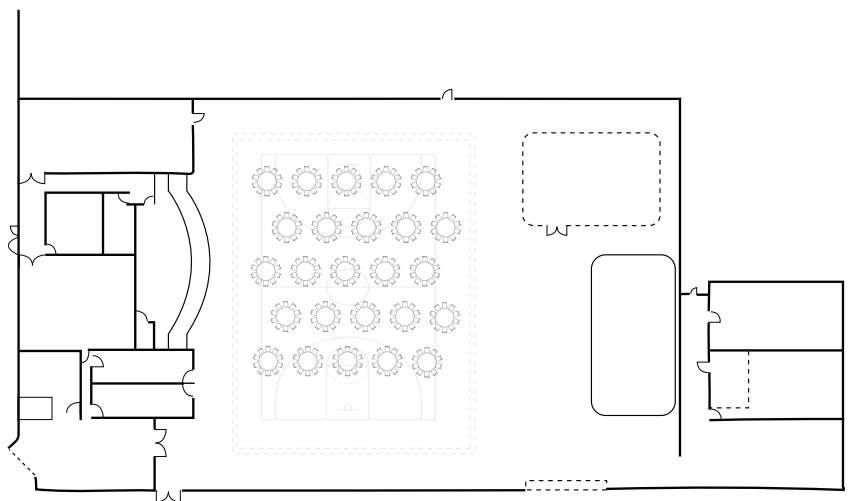



CONTACT CHRISTY BECKMANN

 (262) 432-3026

 [quad@eliteclubs.com](mailto:quad@eliteclubs.com)

 [eliteclubs.com/Quad](http://eliteclubs.com/Quad)



**The Quad is a shape-shifting, spirit-lifting, action-packed, tons of fun for everyone, multi-use activities campus! We can do almost anything!**

- Rental includes: Staff, setup, breakdown, cleaning, and a fun & interactive atmosphere.
- Special requests can be accommodated. Tell us what your needs are and we can customize your experience.
- Bar service available
- Bring in your own food or caterer
- All rental spaces are ADA accessible
- \$450 for two hours (for members)
- includes one staff person for maximum of 50 people and one hour setup time
- Additional add-ons: more setup time, more guests, bartender(s), staff, additional rooms, nonmembers fees
- School outings priced per person, chaperones required



## YOUR NEXT EVENT



Birthday



Graduation



Bar/Bat Mitzvah



Wedding



Family Reunion



Holiday Party



Fundraiser



School Event

